



OBDII CAN Flap Module for F Series

Install Guide

Last Updated: 2/8/15

Use subject to terms and conditions posted at <http://www.burgertuning.com/terms.html>

THIS PART IS LEGAL FOR USE ONLY IN COMPETITION RACING VEHICLES AS DEFINED UNDER CALIFORNIA LAW, AND IS NOT LEGAL FOR USE IN ANY OTHER MOTOR VEHICLE. California law defines a "racing vehicle" as "a competition vehicle not used on public highways." (Calif. Health & Safety Code 39048) This part may only be used on competition racing vehicles operated exclusively on a closed course in conjunction with a sanctioned racing event. Competition-only motor vehicles may not be driven to a racing event on a public highway and must be transported on a trailer or other carrier. USE OF THIS PART IN ANY OTHER VEHICLE MAY SUBJECT YOU TO FINES AND PENALTIES FOR VIOLATION OF FEDERAL AND/OR STATE LAW, WILL VOID YOUR WARRANTY FROM BURGER MOTORSPORTS, LLC, AND CAN VOID YOUR VEHICLE'S WARRANTY. It is your responsibility to comply with all applicable federal and state laws relating to use of this part, and Burger Motorsports, LLC hereby disclaims any liability resulting from the failure to use this part in compliance with all applicable federal and state laws.



This module allows you to control your factory tailpipe exhaust flapper valve from the push of a button. To toggle between full time open, full time closed, and OEM programming, push in the turn signal indicator button for 2+ seconds. The interior only turn signal will flash to indicate the setting you've selected. Left is full time open, right is full time closed, and both is OEM operation. The module remembers the last setting selected and uses that until the mode is changed.

Installation is as simple as plugging the OBDII connector in to your OBDII port. We suggest routing the wire and control box as shown below but the only limit here for mounting is your creativity. Dropping the front kick panel and locating the wiring and box under it will provide a more invisible install if desired.

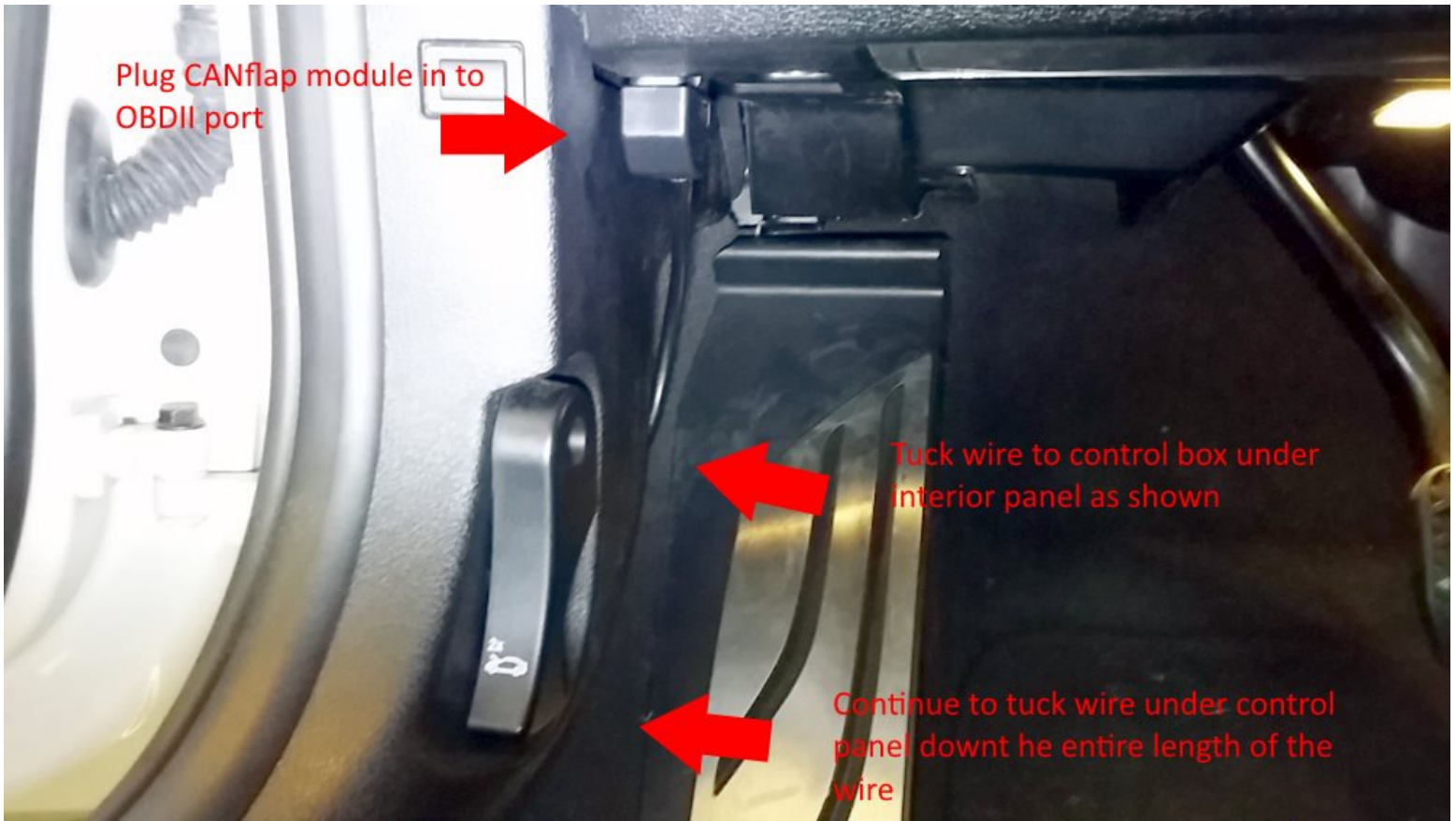

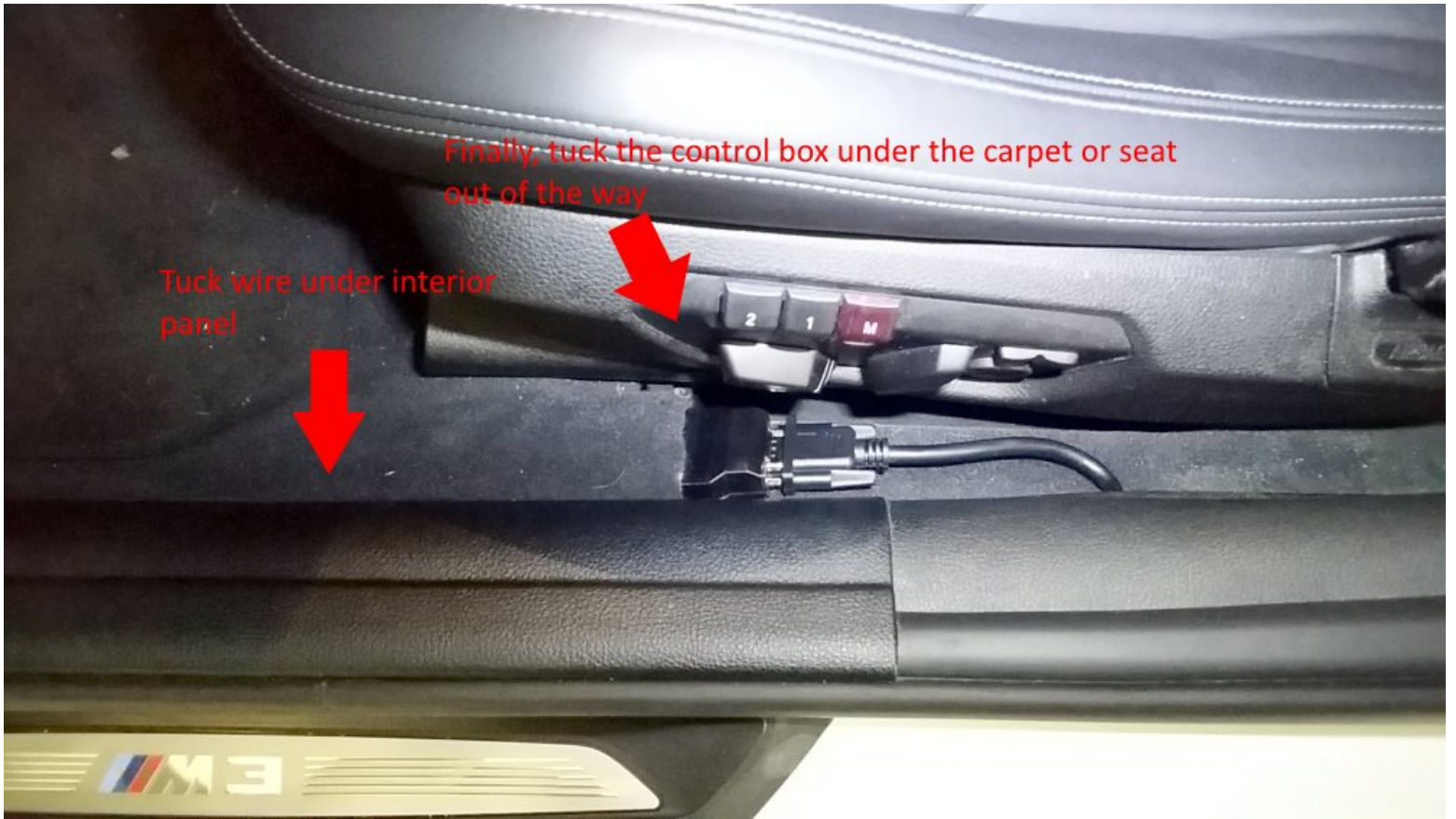

Tuck wire under interior panel

Finally, tuck the control box under the carpet or seat out of the way